



www.jacksongrundy.com

Norton Road, Kingsthorpe, Northampton, NN2 7TL

£180,000 - Guide Price Bungalow

2 1 1



Department: Sales

Tenure: Freehold

Jackson Grundy Estate Agents - Kingsthorpe
66 Harborough Road, Kingsthorpe, Northampton, NN2 7SH

Call Us 01604 722197
Email Us kingsthorpe@jacksongrundy.co.uk





Property Summary

Jackson Grundy is pleased to present to the market this nicely presented semi-detached bungalow situated close to local amenities in the sought after Kingsthorpe location.

Features & Utilities

- ✓ Nicely Presented
- ✓ Semi Detached Bungalow
- ✓ Two Bedrooms
- ✓ Gas Radiator Heating
- ✓ Double Glazing
- ✓ Sought After Location
- ✓ Refitted Kitchen
- ✓ Bay Fronted
- ✓ Multi Fuel Burner
- ✓ Low Maintenance Rear Garden

Property Overview

Jackson Grundy is pleased to present to the market this nicely presented semi-detached bungalow situated close to local amenities in the sought after Kingsthorpe location. The accommodation briefly comprises entrance hall, sitting room, two bedrooms, bathroom and kitchen. Externally to the rear you will find a private rear garden. Further benefits include double glazing throughout and gas central heating. For more information and to book your viewing, please call Jackson Grundy Kingsthorpe on (01604) 722197. EPC Rating: C. Council Tax Band: A

ENTRANCE

Entrance door. Exposed floorboards. Radiator. Access to all rooms and loft access.

BEDROOM TWO 2.88m x 2.52m (9'5 x 8'3)

Double glazed window to front elevation. Radiator.

LOUNGE 4.36m x 2.92m (14'4 x 9'7)

Double glazed bay window to front elevation. Radiator. Multi fuel stove burner.

BEDROOM ONE 3.48m x 2.92m (11'5 x 9'7)

Double glazed window to rear elevation. Radiator.

BATHROOM

Obscured double glazed window to side elevation. Radiator. A three piece bathroom suite to include bath with shower head over, low level WC and wash hand basin. Laminate flooring.

KITCHEN 2.31m x 2.52m (7'7 x 8'3)

Double glazed door opening on to the rear garden. Double glazed window to rear elevation. Stainless steel sink with drainer. Integrated cooking appliances. Wall and base units.

OUTSIDE

FRONT GARDEN

Low maintenance frontage on approach. Pathway to entrance. Enclosed by a brick built retaining wall.

REAR GARDEN

Private rear garden laid to lawn with patio and decked seating area. Enclosed by timber fencing and brick built retaining walls. Shed with power.

MATERIAL INFORMATION

Electricity Supply – Mains Connected

Gas Supply – Mains Connected

Electricity/Gas Supplier – <https://www.ofgem.gov.uk/information-consumers/energy-advice-households/finding-your-energy-supplier-or-network-operator>

Water Supply – Mains Connected

Sewage Supply – Mains Connected

Broadband – <https://www.openreach.com/fibre-checker>

Mobile Coverage – <https://checker.ofcom.org.uk/en-gb/mobile-coverage>

Solar PV Panels – No

EV Car Charge Point – No

Primary Heating Type – Gas Radiators

Parking – No

Accessibility – N/a

Right of Way – No

Restrictions – N/a

Flood Risk – <https://flood-map-forplanning.service.gov.uk/>

Property Construction – Ask Agent

Outstanding Building Work/Approvals – Ask Agent

DRAFT DETAILS

At the time of print, these particulars are awaiting approval from the Vendor(s).

AGENTS NOTES

i Viewings by appointment only through Jackson Grundy ii These particulars do not form part of any offer or contract and should not be relied upon as statements or representation of fact. They are not intended to make or give representation or warranty whatsoever in relation to the property and any intending purchaser or lessee should satisfy themselves by inspection or otherwise as to the correctness of the same iii Photographs illustrate parts of the property as were apparent at the time they were taken iv Any areas, measurements, distances or illustrations are approximate for reference only v We have not tested the appliances, services and specific fittings, an intending purchaser must satisfy himself by inspection by independent advice and/or otherwise to this property.

Floorplan

Ground Floor

Approx. 45.5 sq. metres (489.4 sq. feet)

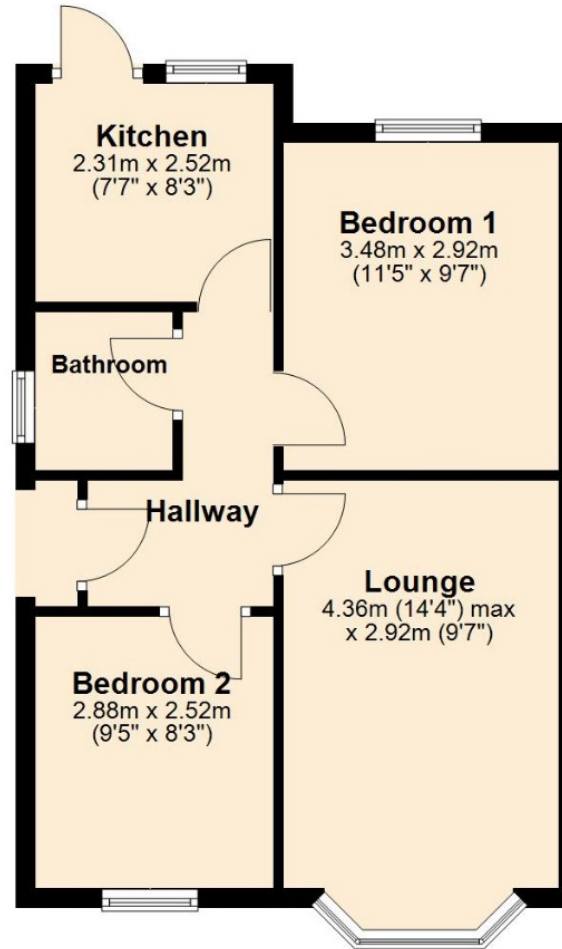

Total area: approx. 45.5 sq. metres (489.4 sq. feet)



Thank you for your interest

Feel free to contact us or submit a viewing request. Our dedicated property experts are available and ready to assist you.

www.jacksongrundy.com

Jackson Grundy Estate Agents is a division of Jackson Grundy Ltd
Registered office: Gough Lodge, Main Road, Duston, Northampton, NN5 6JJ - Company Registration No: 3636152

Jackson Grundy Estate Agents - Kingsthorpe
66 Harborough Road, Kingsthorpe, Northampton, NN2 7SH

Call Us 01604 722197
Email Us kingsthorpe@jacksongrundy.co.uk

