



www.jacksongrundy.com

Kingsthorpe Grove, Kingsthorpe, NN2 6NS

£1,100 - Monthly 26



**Platinum Trusted
Service Award**

Based on service ratings
over the past year

feefo

Department: Lettings

Unfurnished



Jackson Grundy Estate Agents - Kingsley
44 Kingsley Park Terrace, Kingsley, Northampton, NN2 7HH

Call Us 01604 621561
Email Us lettings@jacksongrundy.co.uk





Property Summary

This three bedroom semi-detached home is offered to let by Jackson Grundy. Located in the heart of Kingsthorpe.

Lettings Information

Available From: 30 January 2026

Let Type: Long Term

Features & Utilities

- ✓ Semi Detached Property
- ✓ Three Bedrooms
- ✓ Lounge & Dining Room
- ✓ Kitchen & WC
- ✓ Located In Kingsthorpe
- ✓

Property Overview

This three bedroom semi-detached home is offered to let by Jackson Grundy. Located in the heart of Kingsthorpe, the home is close to many amenities including supermarkets and high street retailers to the Kingsthorpe shopping front. In brief the home comprises lounge, dining room, kitchen and w/c to the ground floor, with three bedrooms and a family bathroom to the first floor. Outside benefits from front and rear gardens and the home is available immediately subject to referencing.

MATERIAL INFORMATION

Type – House

Age/Era – Ask Agent

Deposit – £1,264.92

Council Tax – Band B

EPC Rating – D

Electricity Supply – Mains

Gas Supply – Mains

Water Supply – Mains

Sewerage Supply – Mains

Broadband Supply – Ask Agent

Mobile Coverage – Depends on provider

Heating – Central Heating, Gas Central Heating

Parking – On Street

EV Charging – Ask Agent

Accessibility – Ask Agent

Coastal Erosion Risk – Ask Agent

Flood Risks – Has not flooded in the last 5 years

Mining Risks – Ask Agent

Restrictions – Ask Agent

Obligations – Ask Agent

Rights and Easements – Ask Agent

FEE DETAILS

Refundable Application Holding Deposit: One Weeks' Rent (To reserve a property and refundable if the Landlord decides not to proceed with your application. These monies will not be refunded if you decide not to proceed with the application, fail Right to Rent checks, provide false or misleading information or fail to provide any information needed to proceed with your application within 15 days. If your application is successful these monies will be deducted from your first months' rent). Refundable Security Deposit Five Weeks' Rent: (To cover breaches of agreement. This will be registered and protected with the Tenancy Deposit Scheme (TDS) and may be refunded at the end of the tenancy subject to property inspection). For other Permitted Fees please see the relevant section of the Tenant Guide on our website or visit our offices.

Pet Rent: Should the Landlord accept a pet in the property, the rent will be increased by £25 per month per free roaming pet. Pets are only accepted at the Landlord's discretion and this does not mean that this particular property will accept a pet. Enquiries should therefore be made prior to viewing.

AGENTS NOTES

1. Viewings by appointment only through Jackson Grundy. 2. These particulars do not form part of any offer or contract and should not be relied upon as statements or representation of fact. They are not intended to make or give representation or warranty whatsoever in relation to the property and any intending purchaser or lessee should satisfy themselves by inspection or otherwise as to the correctness of the same. We strongly recommend that all the information we provide be verified by you on inspection, and by your surveyor and conveyancer. 3. Photographs illustrate parts of the property as were apparent at the time they were taken. 4. Any areas, measurements, distances or illustrations are approximate for reference only. 5. We have not performed a structural survey on this property and have not tested the appliances, services and specific fittings, an intending purchaser must satisfy himself by inspection by independent advice and/or otherwise to this property. 6. Whilst we carry out our due diligence on a property before it is marketing and we endeavour to provide accurate information, buyers are advised to conduct their own due diligence. 7. Our information is presented to the best of our knowledge and should not solely be relied upon when making purchasing decisions.

Floorplan

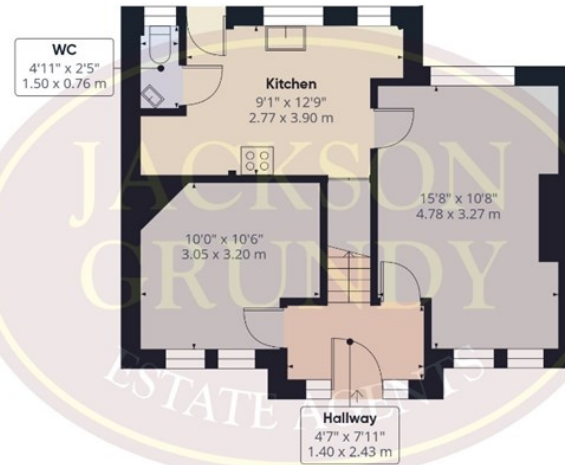

Floor 0



Floor 1



Approximate total area⁽¹⁾

837 ft²

77.9 m²

(1) Excluding balconies and terraces

Calculations reference the RICS IPMS 3C standard. Measurements are approximate and not to scale. This floor plan is intended for illustration only.

GIRAFFE360



Thank you for your interest

Feel free to contact us or submit a viewing request. Our dedicated property experts are available and ready to assist you.

www.jacksongrundy.com

Jackson Grundy Estate Agents is a division of Jackson Grundy Ltd
Registered office: Gough Lodge, Main Road, Duston, Northampton, NN5 6JJ - Company Registration No: 3636152

Jackson Grundy Estate Agents - Kingsley
44 Kingsley Park Terrace, Kingsley, Northampton, NN2 7HH

Call Us 01604 621561
Email Us lettings@jacksongrundy.co.uk

