



www.jacksongrundy.com

Guilsborough Road, Ravensthorpe, Northamptonshire, NN6 8EW

£599,000 Detached

 4  2  2



**Platinum Trusted
Service Award**

Based on service ratings
over the past year

feefo

Department: Sales

Tenure: Freehold



Jackson Grundy Estate Agents - The Village Agency
The Corner House, 1 St Giles Square, Northampton, NN1 1DA

Call Us 01604 624900
Email Us thevillageagency@jacksongrundy.co.uk





Property Summary

Located in the popular and peaceful village of Ravensthorpe is this well presented and extended four bedroom detached family home.

Features & Utilities

- ✓ Extended Family Home
- ✓ Four / Five Bedrooms
- ✓ Kitchen / Dining Room
- ✓ Separate Study
- ✓ En-Suite
- ✓ Private Southerly Facing & Beautiful Garden
- ✓ Quiet Village Location
- ✓ Ample Off Road Parking
- ✓ Double Garage
- ✓ Guilsborough School Catchment

Property Overview

Located in the popular and peaceful village of Ravensthorpe is this well presented and extended four/five bedroom detached family home.

The ground floor boasts a layout which is ideal for families with its sizeable porch and impressively large entrance hall. There is a cloakroom, double garage, study / playroom and sitting room with log burner and views onto the garden. The kitchen / dining room has been extended to create a fantastic family room and hub of the home with views and French doors onto the rear garden.

The first floor has also been extended and now has a principal bedroom with en-suite, bedroom two with dressing room (interconnecting fifth bedroom), a third double bedroom and a single bedroom with fitted wardrobes. There is a four piece family bathroom.

Outside, to the front is a lawned garden with established borders and mature trees, large gravel driveway providing generous amounts of off road parking which leads to the double garage. The garage has light and power connected and has courtesy doors to both the entrance hall and rear garden. The south facing garden to the rear is beautiful and has been well manicured by the current owners. The garden is private and has a large lawned area with established meandering borders housing an abundance of plants and trees. There are multiple decking areas including one leading from the kitchen and sitting room with a Wisteria above.

EPC Rating E. Council Tax Band E.

Floorplan

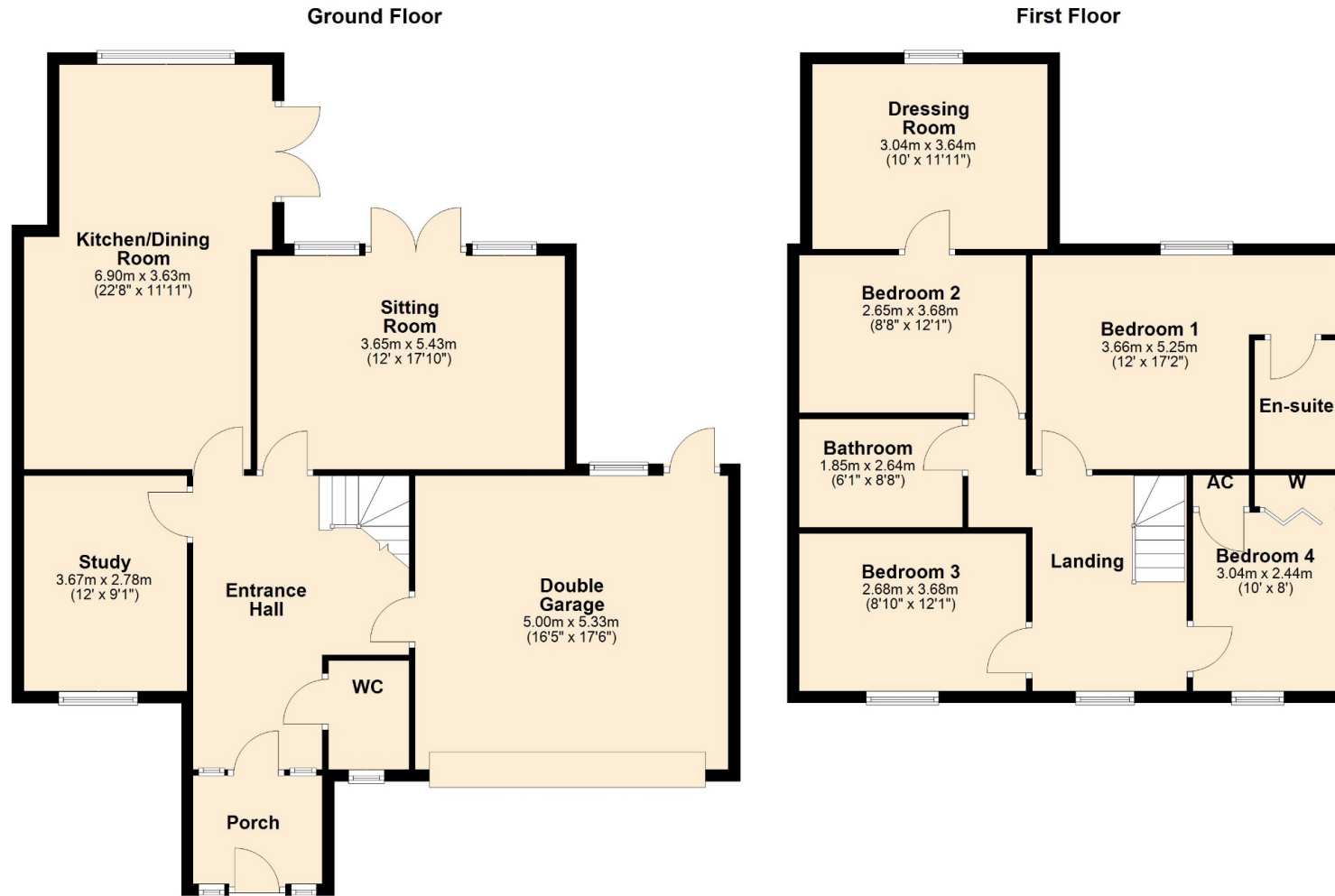



Thank you for your interest

Feel free to contact us or submit a viewing request. Our dedicated property experts are available and ready to assist you.

www.jacksongrundy.com

Jackson Grundy Estate Agents is a division of Jackson Grundy Ltd
Registered office: Gough Lodge, Main Road, Duston, Northampton, NN5 6JJ - Company Registration No: 3636152