



www.jacksongrundy.com

George Lane, Long Buckby, NN6 7EP

£299,000 Semi-Detached

3 1 1



**Platinum Trusted
Service Award**

Based on service ratings
over the past year

feefo

Department: Sales

Tenure: Freehold



Jackson Grundy Estate Agents - Long Buckby
3 Market Place, Long Buckby, Northampton, NN6 7RR

Call Us 01327 842093
Email Us longbuckby@jacksongrundy.co.uk





Property Summary

A fully refurbished three bedroom semi detached house situated on a quiet lane just 30 seconds walk away from the canal. The property has new electrics, heating, kitchen, bathrooms, decoration and carpets plus many other improvements.

Features & Utilities

- ✓ Three Bedrooms
- ✓ Semi Detached
- ✓ Fully Refurbished
- ✓ Large Garden
- ✓ Off Road Parking
- ✓ uPVC Double Glazing
- ✓ No Onward Chain

Property Overview

A fully refurbished three bedroom semi detached house situated on a quiet lane just 30 seconds walk away from the canal. The property has new electrics, heating, kitchen, bathrooms, decoration and carpets plus many other improvements. There is a lounge with fireplace and double doors to the garden, kitchen / dining room, cloakroom, three good size bedrooms and a shower room. The driveway holds two cars and there is a 70ft rear garden. The property is offered with no onward chain. EPC Rating E. Council Tax Band C.

KITCHEN / DINING ROOM 2.79m x 6.83m (9'2" x 22'5")

Window to front and side elevations. Electric heater. Fitted with a range of base units with built in oven, hob and extractor. Sink unit. Space for washing machine and dishwasher.

LOUNGE 4.50m x 5.64m (14'9" x 18'6")

Window and double doors to rear elevation. Electric heater. Fireplace and hearth.

CLOAKROOM

Window to front elevation. Suite comprising WC and wash hand basin with cupboard below.

REAR HALL

Door to garden. Electric heater. Stairs rising to first floor landing.

FIRST FLOOR LANDING

Window to side elevation. Access to loft space.

BEDROOM ONE 4.67m x 3.28m (15'4" x 10'9")

Window to front elevation. Electric heater.

BEDROOM TWO 3.45m x 3.43m (11'4" x 11'3")

Window to front elevation. Electric heater.

BEDROOM THREE 2.79m x 3.68m (9'2" x 12'1")

Window to rear elevation. Electric heater. Original fireplace.

SHOWER ROOM 2.79m x 3.07m (9'2" x 10'1")

Window to rear elevation. Heated towel rail. Suite comprising shower in a large tiled cubicle, WC and wash hand basin.

OUTSIDE

FRONT GARDEN

Driveway for two cars. Water tap. Gated side access.

REAR GARDEN

70ft rear garden with large paved patio area and lawn.

MATERIAL INFORMATION

Type – Semi Detached

Age/Era – Ask Agent

Tenure – Freehold

Ground Rent – Ask Agent

Service Charge – Ask Agent

Council Tax – Band C

EPC Rating – Ask Agent

Electricity Supply – Mains

Gas Supply – No Gas

Water Supply – Mains

Sewerage Supply – Mains

Broadband Supply – Ask Agent

Mobile Coverage – Depends on provider

Heating – Electric Heating
Parking – Driveway
EV Charging – Ask Agent
Accessibility – Ask Agent
Coastal Erosion Risk – Ask Agent
Flood Risks – Has not flooded in the last 5 years
Mining Risks – Ask Agent
Restrictions – Ask Agent
Obligations – Ask Agent
Rights and Easements – Ask Agent

AGENTS NOTES

i Viewings by appointment only through us ii These particulars do not form part of any offer or contract and should not be relied upon as statements or representation of fact. They are not intended to make or give representation or warranty whatsoever in relation to the property and any intending purchaser or lessee should satisfy themselves by inspection or otherwise as to the correctness of the same iii Photographs illustrate parts of the property as were apparent at the time they were taken iv Any areas, measurements, distances or illustrations are approximate for reference only v We have not tested the appliances, services and specific fittings, an intending purchaser must satisfy himself by inspection by independent advice and/or otherwise to this property.

Floorplan

Ground Floor

Approx. 50.1 sq. metres (539.8 sq. feet)

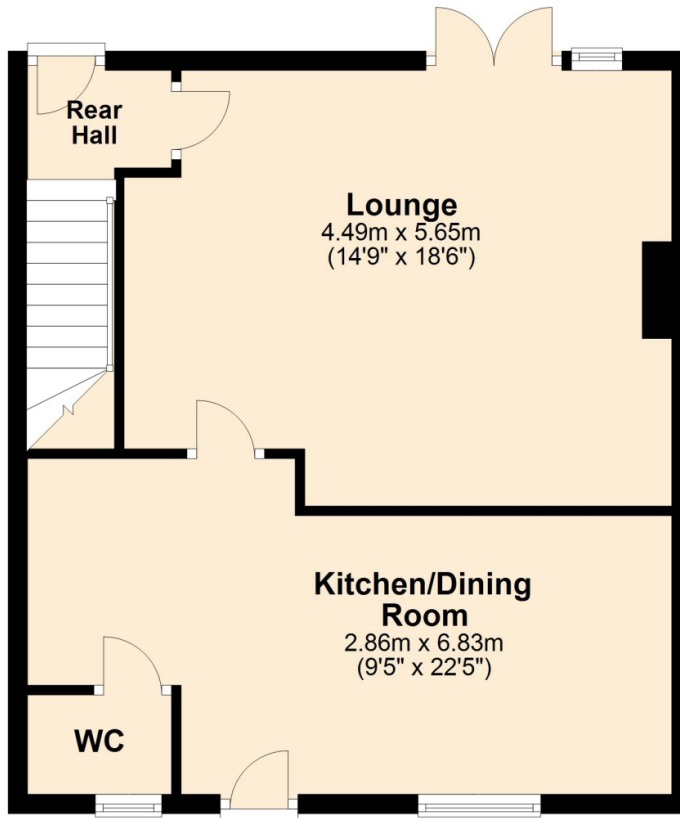

First Floor

Approx. 49.6 sq. metres (533.5 sq. feet)

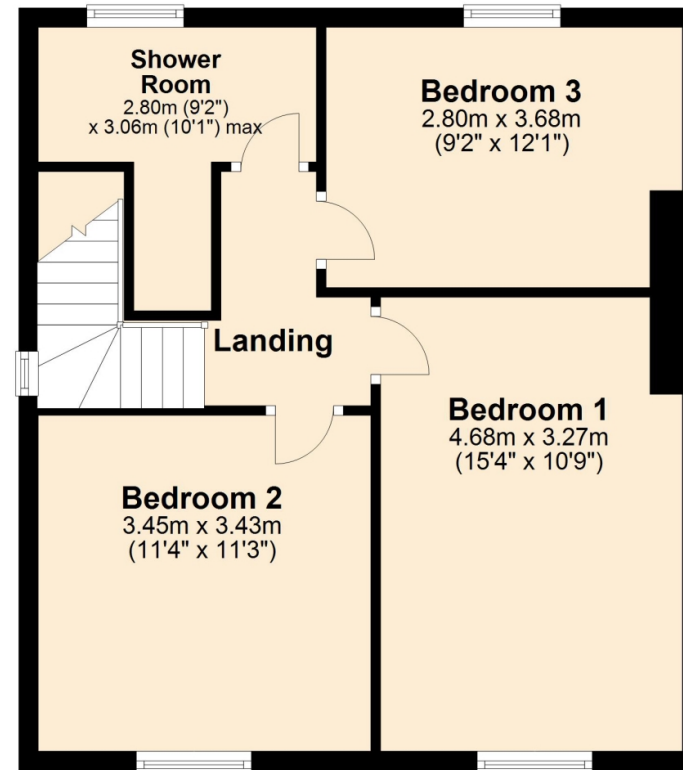

Total area: approx. 99.7 sq. metres (1073.3 sq. feet)



Thank you for your interest

Feel free to contact us or submit a viewing request. Our dedicated property experts are available and ready to assist you.

www.jacksongrundy.com

Jackson Grundy Estate Agents is a division of Jackson Grundy Ltd
Registered office: Gough Lodge, Main Road, Duston, Northampton, NN5 6JJ - Company Registration No: 3636152

Jackson Grundy Estate Agents - Long Buckby
3 Market Place, Long Buckby, Northampton, NN6 7RR

Call Us 01327 842093
Email Us longbuckby@jacksongrundy.co.uk

