



[www.jacksongrundy.com](http://www.jacksongrundy.com)

# Bradshaw Close, Long Buckby, NN6 7XQ

£250,000 End of Terrace

2 1 1



**Platinum Trusted Service Award**

Based on service ratings over the past year

feefo

Department: Sales

Tenure: Freehold



Jackson Grundy Estate Agents - Long Buckby  
3 Market Place, Long Buckby, Northampton, NN6 7RR

Call Us 01327 842093  
Email Us [longbuckby@jacksongrundy.co.uk](mailto:longbuckby@jacksongrundy.co.uk)







## Property Summary

A two bedroom end of terrace property situated in a quiet cul-de-sac. The property has a good sized hall, cloakroom, lounge / dining room with doors leading out onto the garden and a kitchen on the ground floor. To the first floor are two double bedrooms and a bathroom.

## Features & Utilities

- ✓ Two Bedrooms
- ✓ End Of Terrace
- ✓ Off Road Parking
- ✓ Open Plan Lounge / Dining Room
- ✓ Cloakroom
- ✓ Private Landscaped Garden

# Property Overview

A two bedroom end of terrace property situated in a quiet cul-de-sac. The property has a good sized hall, cloakroom, lounge / dining room with doors leading out onto the garden and a kitchen on the ground floor. To the first floor are two double bedrooms and a bathroom. There is off road parking for one car and a private rear garden. There is uPVC double glazing and radiator heating. Offered for sale with no chain. EPC Rating B. Council Tax Band B.

## ENTRANCE HALL

Entrance via double glazed front door. Radiator. Stairs rising to first floor landing.

## CLOAKROOM 1.57m x 1.09m (5'2" x 3'7")

Window to front elevation. Radiator. Suite comprising WC and wash hand basin.

## LOUNGE / DINING ROOM 4.60m x 4.27m (15'1" x 14')

Double doors to the rear garden. Two radiators. Under stairs storage cupboard.

## KITCHEN 3.10m x 1.85m (10'2" x 6'1")

Window to front elevation. Fitted with a range of wall, base and drawer units with work surfaces over. Built in oven, hob and extractor hood. One and a half bowl sink and drainer unit. Space for fridge / freezer and washing machine.

## FIRST FLOOR LANDING

Radiator. Access to loft storage space.

## BEDROOM ONE 2.82m x 4.27m (9'3" x 14')

Window to front elevation. Radiator. Airing cupboard.

## BEDROOM TWO 2.64m x 4.27m (8'8" x 14')

Window to front elevation. Radiator.

### **BATHROOM 2.01m x 2.16m (6'7" x 7'1")**

Chrome heated towel rail. Suite comprising WC, wash hand basin and bath with shower and screen over. Tiled splash backs.

### **OUTSIDE**

#### **FRONT GARDEN**

One parking space.

#### **REAR GARDEN**

Paved patio. Raised flower beds. Lawn. Gated side access.

### **DRAFT DETAILS**

At the time of print, these particulars are awaiting approval from the Vendor(s).

### **AGENTS NOTES**

The Vendor of this property is an employee of Jackson Grundy Estate Agents

### **MATERIAL INFORMATION**

Type – End Of Terrace

Age/Era – Ask Agent

Tenure – Freehold

Ground Rent – Ask Agent

Service Charge – Ask Agent

Council Tax – Ask Agent

EPC Rating – B

Electricity Supply – Mains

Gas Supply – Mains

Water Supply – Mains

Sewerage Supply – Mains



Broadband Supply – Ask Agent  
Mobile Coverage – Depends on provider  
Heating – Gas Central Heating  
Parking – Ask Agent  
EV Charging – Ask Agent  
Accessibility – Ask Agent  
Coastal Erosion Risk – Ask Agent  
Flood Risks – Has not flooded in the last 5 years  
Mining Risks – Ask Agent  
Restrictions – Ask Agent  
Obligations – Ask Agent  
Rights and Easements – Ask Agent

### AGENTS NOTES

i Viewings by appointment only through us ii These particulars do not form part of any offer or contract and should not be relied upon as statements or representation of fact. They are not intended to make or give representation or warranty whatsoever in relation to the property and any intending purchaser or lessee should satisfy themselves by inspection or otherwise as to the correctness of the same iii Photographs illustrate parts of the property as were apparent at the time they were taken iv Any areas, measurements, distances or illustrations are approximate for reference only v We have not tested the appliances, services and specific fittings, an intending purchaser must satisfy himself by inspection by independent advice and/or otherwise to this property.

# Floorplan

## Ground Floor

Approx. 34.1 sq. metres (366.6 sq. feet)

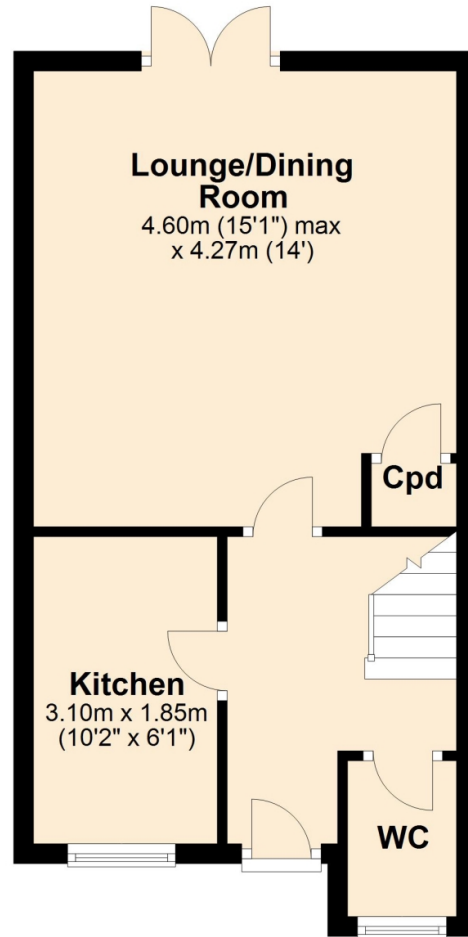

## First Floor

Approx. 33.0 sq. metres (355.0 sq. feet)

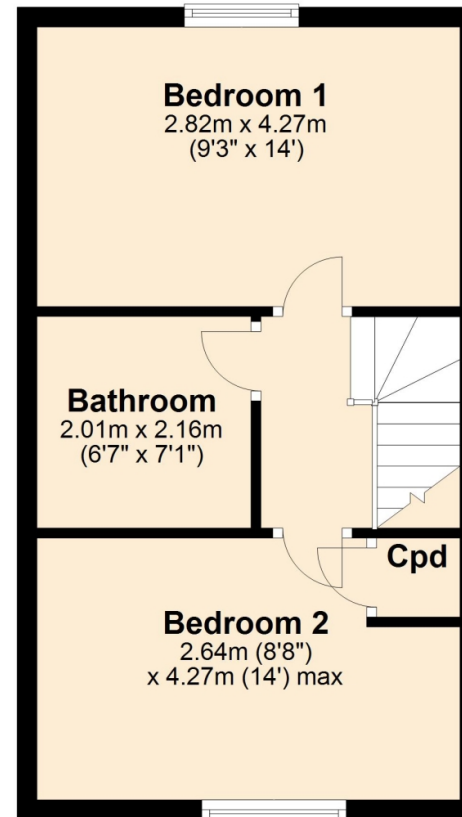

Total area: approx. 67.0 sq. metres (721.6 sq. feet)





# Thank you for your interest

Feel free to contact us or submit a viewing request. Our dedicated property experts are available and ready to assist you.

[www.jacksongrundy.com](http://www.jacksongrundy.com)

Jackson Grundy Estate Agents is a division of Jackson Grundy Ltd  
Registered office: Gough Lodge, Main Road, Duston, Northampton, NN5 6JJ - Company Registration No: 3636152

**Jackson Grundy Estate Agents - Long Buckby**  
3 Market Place, Long Buckby, Northampton, NN6 7RR

**Call Us** 01327 842093  
**Email Us** [longbuckby@jacksongrundy.co.uk](mailto:longbuckby@jacksongrundy.co.uk)

